

1. BLOCKS K & L CHURCH ST. REDEVELOPMENT NEW HAVEN, CONN. SCALE 1"=40' DATED JULY, 1967 REVISED TO 1-16-80 BY CAHN ENGINEERS, INC.
2. PROPERTY TO BE CONVEYED TO CHURCH STREET SOUTH LIMITED PARTNERSHIP NEW HAVEN, CONNECTICUT SCALE 1"=40' DATED FEBRUARY 3, 1984.
3. PROPERTY MAP REUSE PARCEL K-1-8 CHURCH STREET REDEVELOPMENT AND RENEWAL AREA NEW HAVEN, CONNECTICUT SCALE 1"=40' DATED OCT. 1988 REVISED TO 2-22-89 BY GREINER SURVEY AND MAPPING.
4. EASEMENT RELEASE MAP RIGHT OF WAY SURVEY PROPERTY OF NEW HAVEN JEWISH FEDERATION HOUSING CORPORATION & NEW HAVEN JEWISH COMMUNITY COUNCIL HOUSING CORPORATION TOWNE LANE, SOUTH FRONTAGE ROAD & CHURCH STREET EXTENSION NEW HAVEN, CONNECTICUT SCALE 1"=40' DATED JULY 16, 2002 BY GODFREY - HOFFMAN ASSOCIATES.
5. PLAN OF LAND OWNED BY THE CITY OF NEW HAVEN NEW HAVEN, CONN. SCALE 1"=20' DATED AUG. 24, 1970 BY CLARENCE BLAIR ASSOCIATES, INC.

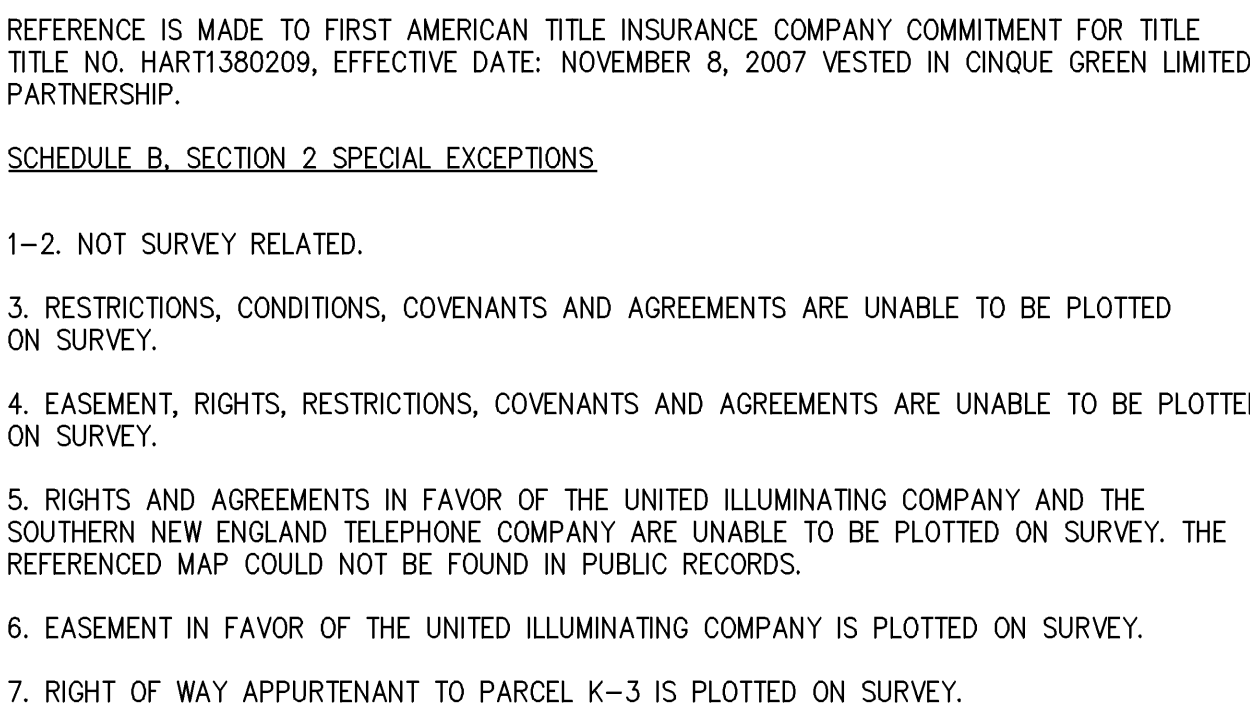

THIS IS TO CERTIFY THAT THIS MAP OR PLAT AND THE SURVEY ON WHICH IT IS BASED WERE MADE IN ACCORDANCE WITH THE "MINIMUM STANDARD DETAIL REQUIREMENTS FOR ALTA/ACSM LAND TITLE SURVEYS", JOINTLY ESTABLISHED AND ADOPTED BY ALTA AND NSPS IN 2005, AND INCLUDES ITEMS 2-4, 6, 8, 9-11, 13, 14, 16, AND 18 OF TABLE A THEREOF PURSUANT TO THE ACCURACY STANDARDS AS ADOPTED BY ALTA AND NSPS AND IN EFFECT ON THE DATE OF THIS CERTIFICATION, UNDERSIGNED FURTHER CERTIFIES THAT IN MY PROFESSIONAL OPINION, AS A LAND SURVEYOR IN THE STATE OF CONNECTICUT, THE RELATIVE POSITIONAL ACCURACY OF THIS SURVEY DOES NOT EXCEED THAT WHICH IS SPECIFIED THEREIN.

THIS SURVEY AND MAP HAS BEEN PREPARED PURSUANT TO THE REGULATIONS OF CONNECTICUT STATE AGENCIES SECTIONS 20-300b-1 THROUGH 20-300b-2 AND THE "STANDARDS FOR SURVEYS AND MAPS IN THE STATE OF CONNECTICUT" AS ADOPTED BY THE CONNECTICUT ASSOCIATION OF LAND SURVEYORS, INC. ON SEPTEMBER 26, 1996.

THIS IS A PROPERTY SURVEY CONFORMING TO A HORIZONTAL CLASS A-2 ACCURACY. THE BOUNDARY DETERMINATION IS A DEPENDENT RESURVEY.

TO MY KNOWLEDGE AND BELIEF THIS MAP IS SUBSTANTIALLY CORRECT AS NOTED HEREON. THIS PLAN IS NOT VALID WITHOUT A LIVE SIGNATURE AND EMBOSSED SEAL.

CHRISTOPHER C. DANFORTH, L.S. #7018 DATE \_\_\_\_\_

## Property Survey

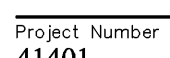



Record Parcel Descriptions

wa 2365 sub 49  
EXHIBIT A  
PARCEL K-3, BLOCK K

All that certain piece or parcel of land situated in the Town and County of New Haven and State of Connecticut and known as Parcel K-3, Block K, Church Street Redevelopment and Renewal Area, containing 15,553 square feet, more or less, and bounded and described as follows:

Commencing at a point, said point being the Southeastern extremity of the median herein described and further having coordinates North 179,092.60 and East 150,941.21 on the Connecticut Geodetic Grid System;

Thence running North 18 degrees 18 minutes 18 seconds East 46.00 feet along land now or formerly of the City of New Haven;

Thence running North 71 degrees 41 minutes 00 seconds East 34.44 feet along land now or formerly of the City of New Haven;

Thence running North 9 degrees 18 minutes 21 seconds East 33.93 feet along land now or formerly of the City of New Haven;

Thence running North 81 degrees 41 minutes 00 seconds East 130.00 feet along land now or formerly of the City of New Haven;

Thence running North 18 degrees 18 minutes 21 seconds East 38.78 feet along land now or formerly of the City of New Haven;

Thence running North 31 degrees 41 minutes 00 seconds East 171.00 feet along land now or formerly of the City of New Haven to the point and place of beginning.

See Rider to Parcel K-3, Block K, at and to Exhibit A

PARCEL K-3, BLOCK K

All that certain piece or parcel of land situated in the Town and County of New Haven and State of Connecticut and known as Parcel K-4, Block K, Church Street Redevelopment and Renewal Area, containing 18,957 square feet, more or less, and bounded and described as follows:

Commencing at a point in the Easterly street line of Church Street, said point being 138.00 feet northerly of the intersection of the Easterly street line of Columbus Avenue and the Easterly street line of Church Street, as measured along the Easterly street line of the aforementioned Church Street, and further having coordinates North 189,789.36 and East 150,487.13 on the Connecticut Geodetic Grid System;

Thence running North 70 degrees 42 minutes 10 seconds East 256.32 feet along land now or formerly of the City of New Haven;

Thence running South 16 degrees 18 minutes 38 seconds East 68.89 feet along land now or formerly of the City of New Haven;

Thence running South 9 degrees 18 minutes 31 seconds East 92.81 feet along land now or formerly of the City of New Haven;

Thence running 107.18 feet in the Westerly direction along the arc of a curve of radius 4,400.00 feet and convex to the South, said arc of a curve being the Easterly street line of Columbus Avenue;

Thence running South 70 degrees 17 minutes 37 seconds East 88.31 feet along the Easterly street line of Columbus Avenue;

Thence running 5 (5) feet along the arc of a curve of radius 4.00 feet and convex to the North;

Thence running North 9 degrees 18 minutes 30.3 seconds East 131.76 feet along the Easterly street line of Church Street to the point and place of commencement.

wa 2365 sub 51  
EXHIBIT A  
PARCEL L-2, BLOCK L

All that certain piece or parcel of land situated in the Town and County of New Haven and State of Connecticut and known as Parcel L-1, Block L, Church Street Redevelopment and Renewal Area, containing 85,446 square feet, more or less, and bounded and described as follows:

Commencing at a point in the Easterly street line of Church Street, said point being, coordinates North 169,100.37 and East 359,060.00 on the Connecticut Geodetic Grid System;

Thence running North 80 degrees 41 minutes 00 seconds East 351.63 feet along land now or formerly of the City of New Haven;

Thence running North 25 degrees 01 minutes 03 seconds East 333.38 feet along land now or formerly of the City of New Haven;

Thence running North 80 degrees 41 minutes 00 seconds East 15.00 feet along land now or formerly of the City of New Haven;

Thence running North 25 degrees 01 minutes 03 seconds East 38.56 feet along land now or formerly of the City of New Haven;

Thence running South 68 degrees 23 minutes 18 seconds East 32.55 feet along land now or formerly of the City of New Haven;

Thence running South 54 degrees 38 minutes 37 seconds East 10.17 feet along land now or formerly of the City of New Haven;

Thence running South 47 degrees 40 minutes 16 seconds East 31.09 feet along land now or formerly of the City of New Haven;

Thence running South 54 degrees 38 minutes 37 seconds East 18.13 feet along land now or formerly of the City of New Haven;

Thence running South 35 degrees 01 minutes 03 seconds East 245.82 feet along the Easterly street line of Union Avenue;

Thence running South 54 degrees 38 minutes 10 seconds East 310.88 feet along the Easterly street line of Union Avenue;

Thence running South 60 degrees 43 minutes 09 seconds East 133.71 feet along land now or formerly of the City of New Haven;

Thence running 6.01 feet in a Easterly direction along a curve of radius 30.06 feet and convex to the East, said arc of curve being the Easterly street line of Church Street;

Thence running North 9 degrees 18 minutes 30.3 seconds East 362 feet along the Easterly street line of Church Street to the point and place of commencement.

wa 2414 sub 561  
EXHIBIT A  
PARCEL L-2, BLOCK L

more or less, situated in the City and County of New Haven, State of Connecticut, Church Street Redevelopment and Renewal Project, said parcel being more particularly described as follows:

Beginning at a point in the division line between land of the City of New Haven and land of the City of New Haven, said point being 90.12 feet northerly of the Easterly street line of Columbus Avenue, when measured along said above division line;

Thence running North 7 degrees 18 minutes 21 seconds East through building 915, a distance of 31.53 feet;

Thence running North 80 degrees 41 minutes 00 seconds East along the Easterly street line of building 910 and land of the City of New Haven, a distance of 1.25 feet;

Thence running North 9 degrees 18 minutes 31 seconds East along the Easterly street line of building 910 and land of the City of New Haven, a distance of 31.53 feet;

Thence running North 80 degrees 41 minutes 00 seconds East along the Easterly street line of building 910 and land of the City of New Haven, a distance of 1.25 feet to the point of beginning;

Said above described piece or parcel of land being more particularly described as in map presented to Common Council, November 20th, 1978, Civil Engineers and Surveyors, New Haven, Conn., entitled:

"Plan of Land Owned by the City of New Haven - New Haven, Conn.", Scale 1" = 25', dated August 20, 1978, as revised January, 1979, a copy of which map shall be filed in the land records of the City of New Haven.

TOGETHER WITH said parcel are subject to the following restrictions, covenants and agreements:

1. The owner, his successors and assigns will not and shall devote the premises to the use specified hereon for said 20,725 square feet adjacent to Parcel 3, Block L of the Church Street Redevelopment and Renewal Project.
2. The owner, his successors and assigns will not and shall not devote the premises to any use other than as specified for said 20,725 square feet adjacent to Parcel 3, Block L, in the Church Street Redevelopment and Renewal Plan, as necessary to any of the applicable limitations or requirements of said Plan.
3. The owner, his successors and assigns will not and shall not disassociate upon the basis of race, color, religion, sex or national origin in the sale, lease or rental or in the use and occupancy of the premises or any improvements located on or to be located thereon, in any part thereof.

wa 2365 sub 50  
EXHIBIT A  
PARCEL K-3, BLOCK K

All that certain piece or parcel of land situated in the Town and County of New Haven and State of Connecticut and known as Parcel K-3, Block K, Church Street Redevelopment and Renewal Area, containing 63,193 square feet, more or less, and bounded and described as follows:

Commencing at a point in the Easterly street line of Columbus Avenue, said point being the Southeastern extremity of the median herein described and further having coordinates North 189,789.36 and East 150,487.13 on the Connecticut Geodetic Grid System;

Thence running North 9 degrees 18 minutes 31 seconds East 100.00 feet along land now or formerly of the City of New Haven;

Thence running North 25 degrees 27 minutes 44 seconds East 60.13 feet along land now or formerly of the City of New Haven;

Thence running North 61 degrees 18 minutes 37 seconds East 60.00 feet along land now or formerly of the City of New Haven;

Thence running South 70 degrees 14 minutes 16 seconds East 57.00 feet along land now or formerly of the City of New Haven;

Thence running North 82 degrees 30 minutes 44 seconds East 48.00 feet along land now or formerly of the City of New Haven;

Thence running North 13 degrees 13 minutes 44 seconds East 160.00 feet along land now or formerly of the City of New Haven;

Thence running South 77 degrees 44 minutes 16 seconds East 21.00 feet along land now or formerly of the City of New Haven;

Thence running North 12 degrees 13 minutes 44 seconds East 39.00 feet along land now or formerly of the City of New Haven;

Thence running South 77 degrees 44 minutes 16 seconds East 21.00 feet along land now or formerly of the City of New Haven;

Thence running 43.13 feet along the arc of a curve of radius 20.00 feet and convex to the South, said arc of curve being the Easterly street line of Columbus Avenue;

Thence running North 84 degrees 30 minutes 44 seconds East 49.43 feet along land now or formerly of the City of New Haven;

Thence running South 5 degrees 18 minutes 16 seconds East 58.00 feet along the Easterly street line of South Orange Street;

Thence running South 7 degrees 18 minutes 30 seconds East 181.40 feet along the Easterly street line of South Orange Street;

Thence running South 61 degrees 31 minutes 30 seconds East 40.13 feet along land now or formerly of the City of New Haven;

Thence running South 7 degrees 20 minutes 16 seconds East 60.00 feet along land now or formerly of the City of New Haven;

Thence running South 82.00 degrees 30 minutes 44 seconds East 47.83 feet along the Easterly street line of Columbus Avenue;

Thence running 181.07 feet in the Westerly direction along the arc of a curve of radius 4,400.00 feet and convex to the South, said arc of a curve being the Easterly street line of Columbus Avenue to the point and place of commencement.

wa 2365 sub 52  
EXHIBIT A  
PARCEL L-3, BLOCK L

All that certain piece or parcel of land situated in the Town and County of New Haven and State of Connecticut and known as Parcel L-2, Block L, Church Street Redevelopment and Renewal Area, containing 72,206 square feet, more or less, and bounded and described as follows:

Commencing at a point in the Easterly street line of Columbus Avenue, said point being, coordinates North 169,401.43 and East 360,466.31 on the Connecticut Geodetic Grid System;

Thence running 182.46 feet in an Easterly direction along the arc of a curve of radius 4,400.00 feet and convex to the South, said arc being the Easterly street line of Columbus Avenue;

Thence running North 82 degrees 30 minutes 44 seconds East 79.75 feet along the Easterly street line of Columbus Avenue;

Thence running South 70 degrees 14 minutes 16 seconds East 133.36 feet along land now or formerly of the City of New Haven;

Thence running South 54 degrees 18 minutes 37 seconds East 96.13 feet along land now or formerly of the City of New Haven;

Thence running South 35 degrees 01 minutes 03 seconds East 177.33 feet along the Easterly street line of Union Avenue;

Thence running North 34 degrees 38 minutes 37 seconds East 18.13 feet along land now or formerly of the City of New Haven;

Thence running North 40 degrees 44 minutes 16 seconds East 31.09 feet along land now or formerly of the City of New Haven;

Thence running North 54 degrees 38 minutes 37 seconds East 18.13 feet along land now or formerly of the City of New Haven;

Thence running North 48 degrees 23 minutes 18 seconds East 48.33 feet along land now or formerly of the City of New Haven;

Thence running North 41 degrees 33 minutes 36 seconds East 54.65 feet along land now or formerly of the City of New Haven;

Thence running North 54 degrees 38 minutes 37 seconds East 47.38 feet along land now or formerly of the City of New Haven;

Thence running North 35 degrees 01 minutes 03 seconds East 40.00 feet along land now or formerly of the City of New Haven;

Thence running North 54 degrees 38 minutes 37 seconds East 34.06 feet along land now or formerly of the City of New Haven;

Thence running North 9 degrees 18 minutes 31 seconds East 127.46 feet along land now or formerly of the City of New Haven to the point and place of commencement.

wa 2365 sub 53  
EXHIBIT A  
PARCEL L-3, BLOCK L

All that certain piece or parcel of land situated in the Town and County of New Haven and State of Connecticut and known as Parcel L-3, Block L, Church Street Redevelopment and Renewal Area, containing 89,423 square feet, more or less, and bounded and described as follows:

Commencing at a point in the Easterly street line of Church Street, said point having coordinates North 145,241.82 and East 359,772.00 on the Connecticut Geodetic Grid System;

Thence running North 9 degrees 18 minutes 30.3 seconds East 256.00 feet along the Easterly street line of Church Street;

Thence running North 80 degrees 41 minutes 00 seconds East 23.00 feet along land now or formerly of the City of New Haven;

Thence running North 11 degrees 42 minutes 33 seconds East 55.00 feet along land now or formerly of the City of New Haven;

Thence running North 70 degrees 17 minutes 37 seconds East 48.36 feet along the Easterly street line of Columbus Avenue;

Thence running 107.00 feet in an Easterly direction along a curve of radius 4,400.00 feet and convex to the South, said arc being the Easterly street line of Columbus Avenue;

Thence running South 9 degrees 18 minutes 31 seconds East 114.00 feet along land now or formerly of the City of New Haven;

Thence running North 80 degrees 41 minutes 00 seconds East 42.00 feet along land now or formerly of the City of New Haven;

Thence running North 8 degrees 18 minutes 31 seconds East 40.05 feet along land now or formerly of the City of New Haven;

Thence running North 54 degrees 38 minutes 37 seconds East 18.13 feet along land now or formerly of the City of New Haven;

Thence running North 35 degrees 01 minutes 03 seconds East 6.00 feet along land now or formerly of the City of New Haven;

Thence running South 54 degrees 38 minutes 37 seconds East 47.38 feet along land now or formerly of the City of New Haven;

Thence running North 35 degrees 01 minutes 03 seconds East 40.00 feet along land now or formerly of the City of New Haven;

Thence running North 54 degrees 38 minutes 37 seconds East 18.13 feet along land now or formerly of the City of New Haven;

Thence running North 80 degrees 41 minutes 00 seconds East 12.50 feet along land now or formerly of the City of New Haven;

Thence running South 35 degrees 01 minutes 03 seconds East 130.52 feet along land now or formerly of the City of New Haven;

Thence running North 54 degrees 38 minutes 37 seconds East 36.30 feet along land now or formerly of the City of New Haven;

Thence running North 35 degrees 01 minutes 03 seconds East 30.00 feet along land now or formerly of the City of New Haven;

Thence running North 26 degrees 18 minutes 37 seconds East 48.64 feet along land now or formerly of the City of New Haven;

wa 2365 sub 54  
EXHIBIT A  
PARCEL L-3, BLOCK L (continued)

Thence running South 80 degrees 41 minutes 00 seconds East 90.27 feet along land now or formerly of the City of New Haven;

Thence running South 9 degrees 18 minutes 30 seconds East 14.00 feet along land now or formerly of the City of New Haven;

Thence running South 60 degrees 41 minutes 00 seconds East 25.00 feet along land now or formerly of the City of New Haven to the point and place of commencement.

Rider to Parcel K-3, Block K

Together with a right of way for purposes of ingress and egress to, from, over and upon that parcel of land adjoining Parcel K-3 on the West, South and East and fronting on South Orange Street and Church Street South as shown on the map hereinafter referred to:

Reference is hereby made to a map by Cain Engineers, Civil Engineers and Surveyors of New Haven, Connecticut, and entitled, "Blocks K and L, Church Street Redevelopment, New Haven, Connecticut," Scale 1" = 40 feet, dated July, 1965, and revised in October, 1968, a copy of which map is filed as Exhibit "B" to this Land Disposition Agreement.

**VHIB**  
Vanasse Hangen Brustlin, Inc.

Transportation  
Land Development  
Environmental Services

54 Tuttle Place  
Middletown, Connecticut 06457  
860-632-1500 • FAX 860-632-7879

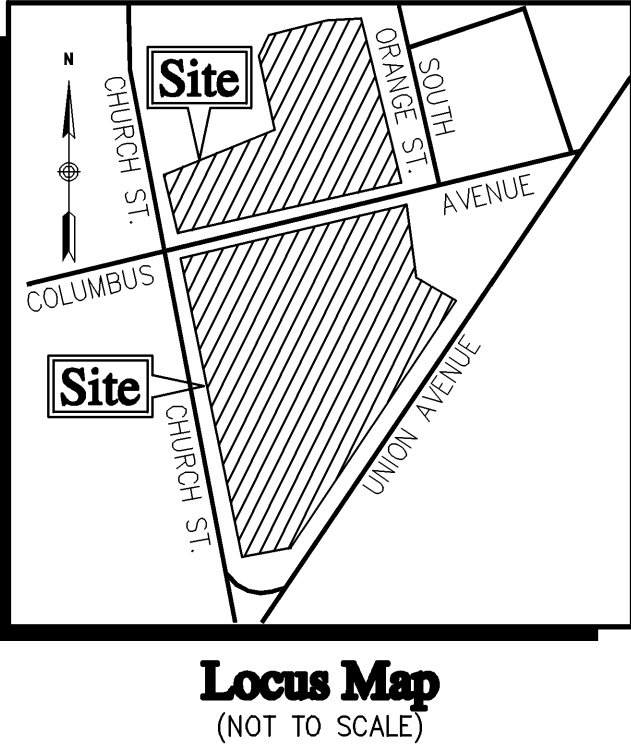

No.	Revision	Date	Appr.
Designed by	Drawn by	Checked by	
CAD checked by	Approved by		
Scale	None	Date	February 19, 2008
Project Title			

Northland, Church And South Street  
Parcels K-3, K-4, K-5, L-1, L-2, L-3  
Union Ave., Church St. So. & South Orange St.  
New Haven, Connecticut  
Issued for  
ALTA/ACSM Land  
Title Survey

Drawing Title

Descriptions

THIS IS TO CERTIFY THAT THIS MAP OR PLAT AND THE SURVEY ON WHICH IT IS BASED WERE MADE IN ACCORDANCE WITH THE "MINIMUM STANDARD DETAIL REQUIREMENTS FOR ALTA/ACSM LAND TITLE SURVEYS", JOINTLY ESTABLISHED AND ADOPTED BY ALTA AND NSPS IN 2005, AND INCLUDES ITEMS 2-4, 6, 8, 9-11,13, 14, 16, AND 18 OF TABLE A THEREOF, PURSUANT TO THE ACCURACY STANDARDS AS ADOPTED BY ALTA AND NSPS AND IN EFFECT ON THE DATE OF THIS CERTIFICATION, UNDERSIGNED FURTHER CERTIFIES THAT IN MY PROFESSIONAL OPINION, AS A LAND SURVEYOR IN THE STATE OF CONNECTICUT, THE RELATIVE POSITIONAL ACCURACY OF THIS SURVEY DOES NOT EXCEED THAT WHICH IS SPECIFIED THEREIN."

TO MY KNOWLEDGE AND BELIEF THIS MAP IS SUBSTANTIALLY CORRECT AS NOTED HEREON. THIS PLAN IS NOT VALID WITHOUT A LIVE SIGNATURE AND EMBOSSED SEAL.

Drawing Number

**Sv-3**

Sheet 3 of 3

Project Number 41401